

GODOX设计文件图注

项目类型 彩盒 彩卡 白盒 贴纸 说明书 内托 胶盒 吸塑 其他:			
项目名称 神牛-PB960说明书			
产品料号 82.A0PB9600-00		版本 A	
展开尺寸 (mm) 350x200mm		成品尺寸 (mm) 70x200mm	
尺寸公差 ±2mm			
材质 铜版纸128g			
工艺说明 黑白印刷; 折页			
备注/色值			
设计师	YOYO	校对	JESSICA



FBP4500

Flash Power System



Thank you for choosing the ProMaster FBP4500

- The ProMaster FBP4500 lithium power pack is designed to charge speedlites with external power input ports, including on-camera flashes from ProMaster, Canon, Nikon, Sony, and others.
- When you use the ProMaster FBP4500 with a compatible speedlite it takes as little as 1 second to charge your flash to maximum power. You will typically get as many as 1800 full power flashes from a fully charged FBP4500.
- The FBP4500 MCU (Micro-Controller Unit) integrates software and hardware protection for your flash. The heat-resistant nylon plastics ensures high reliability with safe operation.

Features

- Large-capacity lithium battery (11.1V/4500mAh), which can provides fast recycling and up to 1800 full-power flashes.
- Dual outputs will power two separate flashes without reducing recycle time
- Removable and replaceable battery module. Double your flash capacity by purchasing a second module.
- Concise LED display panel, easy and fast to control
- Optimized MCU circuit design, more efficient energy conversion and more flashes.

Warning

- There are high-voltage components inside the product. Do not disassemble or attempt to repair by yourself. Opening the unit could result in electric shock and potential serious injury.
- Keep out of the reach of children.
- Do not touch the metal parts of the plug and the socket.
- Do not use this product under flammable conditions (such as areas containing flammable gases or liquid chemicals). Using so or it may result in fire or explosion and potential serious injury.
- Make sure all plugs and sockets are properly connected. A poor connection could result in shock or injury.

Caution

- This product is not water resistant. Please keep it away from rain, snow or humidity.
- Please do not leave or use this product at a temperature of above 104°F.
- Since this product has a much higher power output than the ordinary built-in battery of the flash, the flash may be damaged when used at high frequency and high power. To avoid overheating of the flash, please allow a break of about 10 minutes after 40 continuous full-power flashes.
- Only insert or remove the power connector cable when the battery pack is OFF.

I. Names of Parts

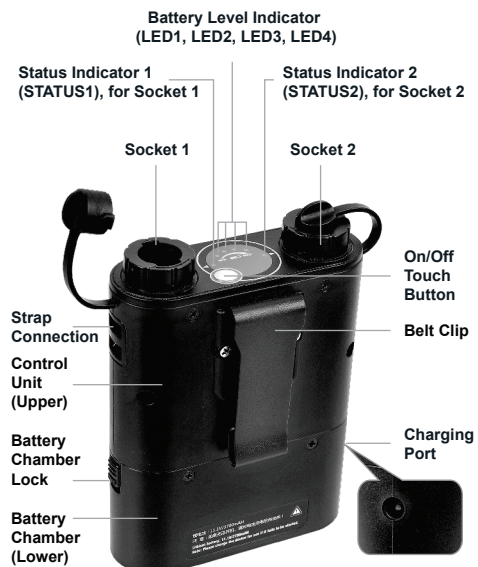

Accessories

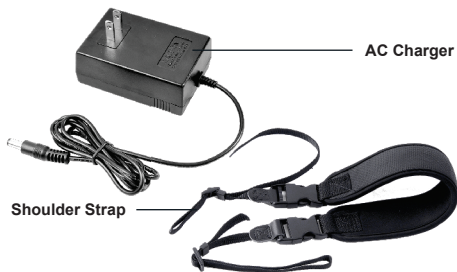

II. Loading/Unloading Battery Chamber

Loading:

- Fit the control unit to the battery chamber;
- Slide the battery chamber to the left until it locks into place with a "click".

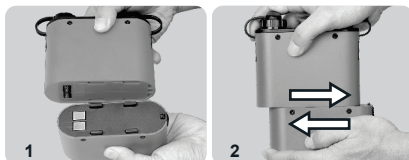

Unloading:

- Slide the battery chamber lock downwards;
- Slide the battery chamber to the right.

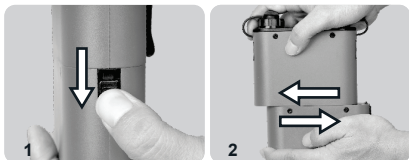

III. Charging the Battery

- Insert one end of the AC charger into an AC socket (100-240V) and the other end into the charging port of the power pack. If the charger indicator turns red, the battery is being charged. If the charger indicator turns green, the battery is fully charged. It takes about 3 hours to fully charge the battery.

IV. Operation

(i) Start-up



- Select a connector cable that is compatible with your flash.

- Connect the power plug of the connector cable to socket 1 or 2 of the power pack.



- Insert the terminal of the connector cable into the flash.

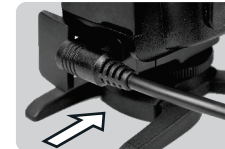

- Press the On/Off touch button. The LED battery level indicators will light up, indicating the power pack is ready to use.

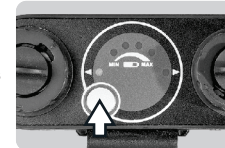

Note: Your flash must have batteries with sufficient power installed for this unit to function.

(ii) Power-off

- Turn the power pack off by pressing the On/Off touch button.
- Unplug the connector cable from the power pack.

V. Power Pack Status

- Power-off status:** There is no LED indication, and no power output from socket 1 or 2.
- Test status:** When the connector cable is not inserted into socket 1 or 2, press the On/Off test button. The battery level indicators light up, indicating the power pack is in the test mode. Press the On/Off touch button again or wait for 3 seconds and the power pack will return to power-off status.
- Working status:** Insert the connector cable into socket 1 or 2 and press the On/Off touch button, and the LED indicators light up, indicating the power pack is in the working status. Press the On/Off touch button again or unplug the connector cable from socket 1 or 2 to enter the power-off status.

* Automatic Power-Off Function:

The power pack automatically powers off after twelve hours to prevent battery drain in the event the battery is not powered off after use.

VI. LED Indicators

1. Battery Level Indicators: LED1, LED2, LED3, LED4

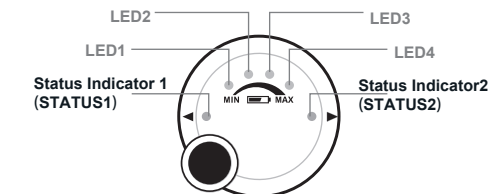

LED	LED1	LED2	LED3	LED4
Battery level				
Weak	Blinking	OFF	OFF	OFF
Low	ON	OFF	OFF	OFF
Middle	ON	ON	OFF	OFF
Almost full	ON	ON	ON	OFF
Full	ON	ON	ON	ON

- Be sure to charge the battery according to the indication of the LEDs.
- When LED1 is blinking, your power pack will no longer provide power output; the battery needs to be charged before it can be used again.

Note: If the device will not power on, try charging the battery pack.

2. Status Indicators: STATUS1, STATUS2

- STATUS1/STATUS2 are off when charging the flash and will light up when the flash is fully charged.
- STATUS1/STATUS2 blinks (blinking cycle: 1Hz), indicates that the flash has been overused. In case of excessive temperature inside the power pack, the overheat protection will be enabled and the power output suspended. Please wait for at least 10 minutes before using it again.

VII. Technical Data

Battery pack	Lithium battery-11.1V/4500mAh
Battery charging time	Approx. 3 hours
Flash recycling time	Approx. 1s (at full power)
Number of Flashes	Approx. 1800 times
Dimension	159*133.5*49.2MM
Weight	540G

IX. Maintenance

- This unit contains no user serviceable parts. Should your unit require service, return it to your ProMaster Dealer or directly to ProMaster.

Warranty

ONE YEAR UNCONDITIONAL GUARANTEE

If for any reason, this ProMaster product fails within ONE YEAR of the date of purchase, return this product to your ProMaster dealer and it will be exchanged for you at no charge.

ProMaster products are guaranteed for ONE FULL YEAR against defects in workmanship and materials. If at any time after one year, your ProMaster product fails under normal use, we invite you to return it to ProMaster for evaluation.

PB 960 电源盒 PROPAC



感谢您使用神牛



- 神牛PB960电源盒是一款专业的电源充电产品，可为佳能、尼康、索尼和神牛等品牌中带外置电源输入端口的机顶闪光灯充电。使用神牛PB960电源盒，佳能580EX II、尼康SB900和索尼F58AM等三款闪光灯的最大功率充电时间仅需一秒，全功率闪光大约1800次，极大的提高了拍摄效率和使用时间。同时，产品兼容性强，仅需更换插拔式的端子连接线即可对不同品牌的闪光灯及其他产品（如iPhone）进行充电。
- 神牛PB960采用MCU控制，内有软件保护和硬件保护两种保护措施，外壳采用耐高温尼龙料，产品更安全可靠。

特点

- 大容量锂电池（11.1V/4500mAh）供电，使用佳能580EX II可引闪光约1800次。
- 双头独立输出，性能更加稳定安全，接2只闪光灯回电速度不会减慢。
- 独立电池盒，可从主机拆卸。可交互使用可使引闪光次数高达3600次。
- 简洁的显示面板，用户使用更加得心应手。
- 优化的MCU控制线路，使能量转换更加高效，引闪光次数更多。

警告

- ▲ 本产品内部有高压元器件，请不要自行打开或进行维修，以免触电。
- ▲ 请不要让儿童接触本产品。
- ▲ 请不要触摸插头和插座上的金属部分。
- ▲ 请不要在含有易燃气体、液体化学物质等易燃物体的环境下使用本产品，有可能会引起火灾。
- ▲ 确保所有插头和插座是可靠稳固连接的。

注意事项

- △ 本产品没有防水功能，请不要在雨、雪、高湿度环境下使用。
- △ 请不要将本产品放置在40度以上的环境下使用。
- △ 由于本产品电力输出强于闪光灯内置的普通电池，高频率大功率使用会损坏闪光灯。为避免闪光灯过热，请不要在全功率时连续闪光40次，请停止稍候10分钟左右再继续使用。
- △ 请在本产品关机状态下插上或者拔出插头。

一、部位名称



● 附件：



二、电源盒装卸

- 安装：(1) 控制盒与电池盒相扣；(2) 电池盒往左推正，听到“嗒”声即已锁紧。

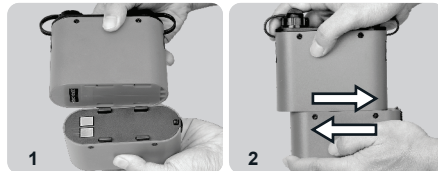

- 拆卸：(1) 下推“电池盒锁件”；(2) 电池盒往右推出电池盒。

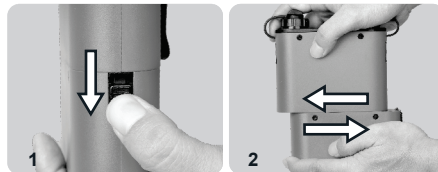

三、电池充电

- 将充电器的一头插入AC插座（100-240V），另一头插入电池盒的充电插孔，充电器指示灯亮红灯，表示正在充电，充电器指示灯亮绿灯，表示已经充满，电池充电时间约3个小时。

四、如何使用

(一) 开机使用



- 选择跟您的产品兼容的端子连接线。

- 将端子连接线的电源插座端接到电源盒的输出插座上；



- 将端子连接线的端子头插入闪光灯；

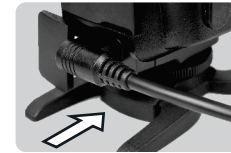

- 按下轻触按键，电量显示LED灯珠亮起，电源盒开始工作。

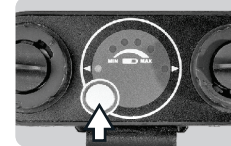

注意：如果用在闪光灯上，闪光灯上也必须装有电池且电量足够运作闪光灯。

(二) 关机

- 按下轻触按键，即可关闭电源盒；
- 直接将端子连接线从电源盒拔出即可关闭电源盒。

五、电源盒相关状态说明

- 关机状态：LED没有显示，此时“输出插座”没有电源输出，整机耗电极小，对电池电量的损耗可忽略不计。
- 探测状态：端子连接线没有插在“输出插座”上，按下“轻触按键”即进入探测状态，此时只有电量显示灯亮起，重按按钮或3秒后自动返回关机状态。
- 工作状态：端子连接线插在“输出插座”上，按下“轻触按键”，LED灯亮起，即进入工作状态。再次按下“轻触按键”或者从“多功能插座”拔出端子连接线将会进入关机状态。
* 定时关机功能：开机定时12小时自动关机，防止在不使用时忘记关机，导致长时间耗电。

六、LED显示

1、电量显示：LED1，LED2，LED3，LED4

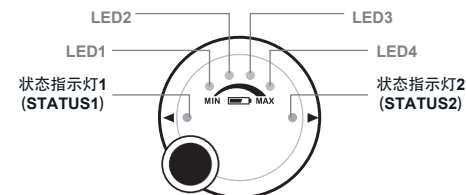

电量	LED1	LED2	LED3	LED4
极低	闪烁	OFF	OFF	OFF
低	ON	OFF	OFF	OFF
中	ON	ON	OFF	OFF
中上	ON	ON	ON	OFF
高	ON	ON	ON	ON

- 根据LED灯的显示，请及时对电池充电；
- 当LED1闪烁时，设备会停止电量输出，需立即对电池充电后方可使用。

注意：如果不能开机，请对电池充电后再使用。

2、状态指示灯：STATUS1，STATUS2

- 如果状态指示灯闪烁（闪烁周期1HZ），表示闪光灯使用过度，电源盒内部温度过高导致过热保护启动，将停止能量输出，放置10分钟以上后方可使用。

七、规格

- 使用神牛PB960电源盒，佳能580EX II、尼康SB900和索尼F58AM等三款闪光灯的最大功率充电时间仅需一秒，全功率闪光大约1800次。

神牛PB960电源盒

1800次

159*33.5*49.2MM

540G

八、警告

未严格按照使